

See why leading  
brands rely on us  
for their entrances  
and storefronts.



**Oldcastle** BuildingEnvelope®

*Engineering your creativity™*



# As the leader in building envelope design and technology our expertise is **unequaled.**

### LEADING-EDGE TECHNOLOGY

We are revolutionizing how buildings are built with leading-edge technologies. Those technologies are applied to everything we do.

While other manufacturers are jumping on the building envelope bandwagon, we are once again redefining it. We've more than put our money where our mouth is with significant investments in revolutionary products, ground-breaking BIM technologies and better ways to close a building's envelope. And it's that level of thinking and commitment that the nation's leading brands and corporations have come to rely on for their first impressions. At Oldcastle BuildingEnvelope®, first impressions extend beyond traditional entrance doors and storefronts. We design, engineer, manufacture, manage, procure and deliver every aspect of the building envelope including storefronts and entrances, curtain wall, architectural glass, sunshades, inset panels, skylights and windows.

Why do we do it? Leading retailers, hospitals, hotels, government agencies and more are asking for it. Unlike traditional storefront manufacturers, we provide one integrated solution. And whether your next project has five or 500 locations—we have a manufacturing plant everywhere you have a project. Welcome to a different way of doing things. Welcome to Oldcastle BuildingEnvelope®.



### TRACK RECORD WITH BIG BRANDS

Our pursuit of excellence is one of the things America's best-known brands and corporations expect from us.

**CUSTOMERS INCLUDE**

- Henri Bendel
- Banana Republic
- AutoZone
- Victoria's Secret
- Crate and Barrel
- Limited Brands
- Kohl's
- GAP
- Chico's
- Wendy's
- Target
- Maserati
- Infiniti



### RETAIL IS JUST THE BEGINNING



HOSPITALITY



HEALTHCARE



OFFICE



EDUCATION



# From design to done.



Whether you know exactly what you want your storefront to look like or you are starting with a clean sheet of paper, we offer complete storefront design and engineering capabilities.

Cookie-cutter? No. Custom? Yes. Complicated? Never. Unlike local storefront manufacturers, our unique design and engineering process provides for different store sizes, geographical aesthetic differences, local ordinances, etc. ahead of time. What does that mean to you? Once we finalize your storefront concept, we are able to replicate it across multiple locations. No learning curve, no wasted effort, no additional time.

**1 CUSTOM-ENGINEERED CURTAIN WALL AND MONUMENTAL STOREFRONTS**

We are an unquestioned leader at pushing the limits of customized curtain wall systems.

**2 STOREFRONTS AND ENTRANCE DOORS**

We design, engineer and manufacture fully integrated all-glass entrances, aluminum and glass storefront systems and aluminum entrance doors.

**3 ARCHITECTURAL GLASS**

We offer the industry's most comprehensive selection of architectural glass products including high-performance, structural, hurricane, blast-resistant and more.

**4 SUNSHADES AND CANOPIES**

Our complete sunshade offering integrates seamlessly with all of our products and provides aesthetic and performance benefits.

**5 INSET PANELS AND ACCESSORIES**

We design and manufacture all of a storefront's inset panels and accessories in our manufacturing plants, including custom-colored finishes.







# So why choose us as your building envelope supplier?

## 1 THE FIRST AND ONLY BUILDING ENVELOPE COMPANY

Sure other “me-too” manufacturers may promise to provide integrated solutions from one source—only Oldcastle BuildingEnvelope® actually does.

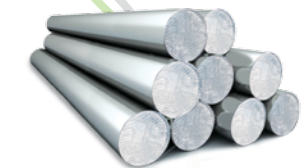

## 2 FROM RAW MATERIALS TO FINISHED STOREFRONT

Unlike traditional storefront suppliers—with us, there are no middlemen. We start with raw aluminum billet and glass so we are never delayed waiting for other suppliers.



## 3 CRITICAL CONSISTENCY

Need a color matched exactly the same way at 195 different locations all across North America? No problem.

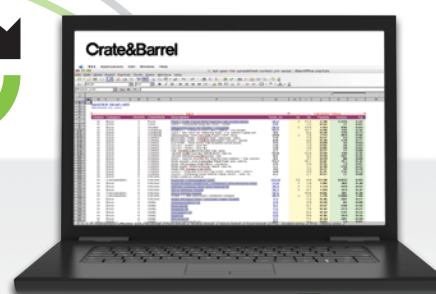
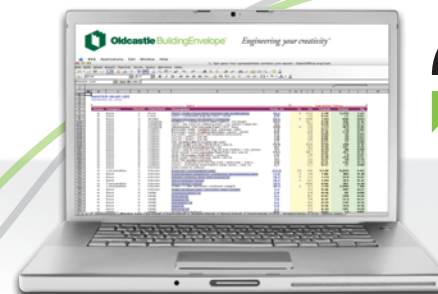

## 4 UP-TO-THE-MINUTE SCHEDULING

We track each of your project's critical path tasks and update you so there are no surprises.



## 9 THE BEST NATIONAL ACCOUNTS TEAM

We have some of the most experienced engineers, project managers and sales representatives in the industry—ready for your next challenge.

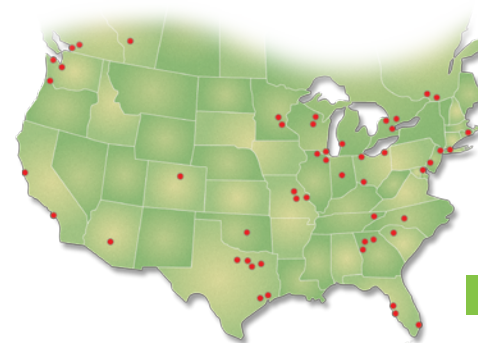

## 6 WE HAVE THE LARGEST NATIONAL FOOTPRINT

Whether your next project has one or 500 locations and is in Palm Springs or Providence, we have a manufacturing location nearby.

## 5 INTERFACE WITH YOUR INTERNAL TOOLS

We can sync our internal documentation and data with yours, seamlessly. We figure out how to work with you, not the other way around.

## 8 ONE WARRANTY

Peace of mind. Why juggle multiple manufacturers' warranties when you can have just one?



## 7 AN INTEGRATED APPROACH

Our approach is one of integration: integrated products, processes and stakeholders. The American Institute of Architects calls it Integrated Project Delivery (IPD). It's an approach that focuses on increased collaboration among all parties involved in a building's construction. We approach each project the same way.

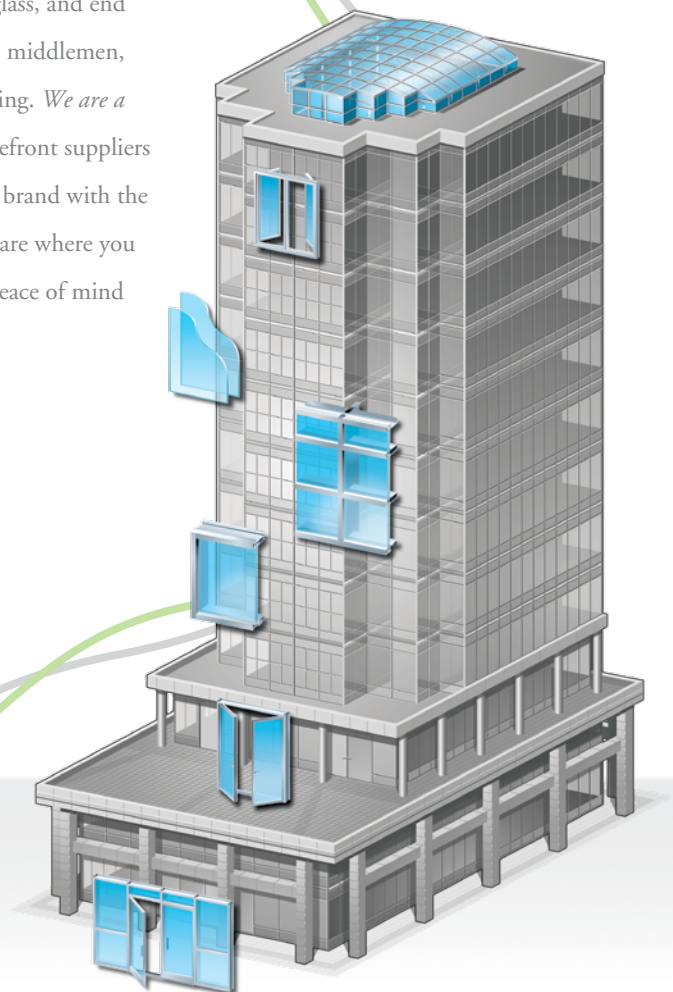





**RETAIL**



**HEALTHCARE**



# We are everywhere.

From Tampa to Tahoe, our custom-engineered storefronts grace some of America's most discerning entrances. And we have experience in all industries: hospitals, shopping malls, convention centers, airports, hotels, museums, universities, government and more.



**EDUCATION**

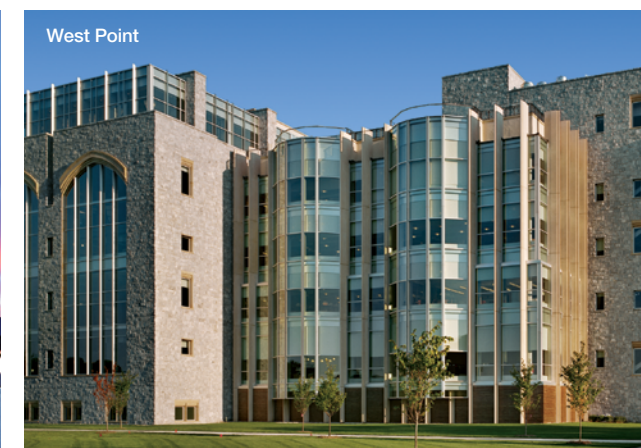

**HOSPITALITY**



**OFFICE**





# Entrances & Storefronts

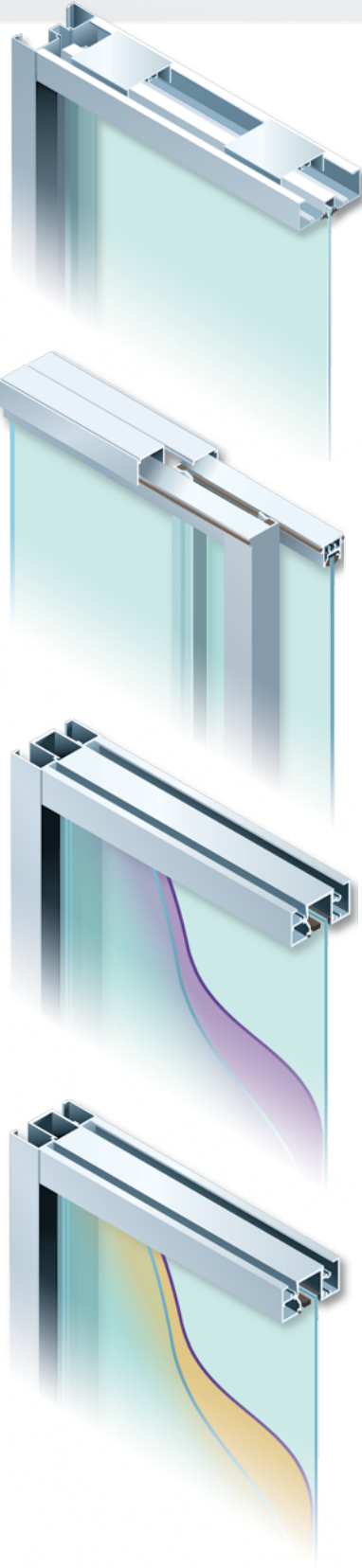

## NEW THERMAL: STOREFRONT

Thermal storefronts feature a poured-and-debrided thermal break design to enhance energy performance while maintaining a sleek 2" x 4-1/2" profile. The thermal clip systems are 1-3/4" or 2-1/4" wide with multiple depths available. Thermal break construction helps lower heating and cooling costs and reduces potential for condensation.

### Performance

- Air Tests per ASTM: E283
- Water Penetration Testing per ASTM: E331
- Uniform Load Tests per ASTM: E330
- Thermal Testing per AAMA: 1503 and NFRC; NFRC Non-thermal storefronts tested per Florida Building Code and ASTM for shuttered applications

## NEW THERMAL: SLIDING MALL FRONT

Our full line of mall sliders and sliding storefronts include aluminum stile and rail and all-glass models with single direction or bi-parting multi-track and single-track 90-degree or parallel stacking options.

### Performance

- Air Infiltration: Not to exceed 0.06 cubic feet per minute per square foot of wall area when tested at 6.24 PSF per ASTM E283
- Water Infiltration: Not less than 15 PSF when tested per ASTM E331

## BLAST MITIGATION: BLASTMAX™ FG-5100 Series

BlastMax™ FG-5100 is a heavy-duty, flush-glazed storefront that offers very high levels of blast protection. This system can offer both blast and hurricane protection. Our blast mitigation system is unique in that the curtain wall and the glass are engineered and tested together as one system.

### Performance

- ASTM: F1642
- UFC (DoD) 4-010-01
- GSA / ISC
- ASTM: E1886, E1996
- Florida Building Code: TAS 201, 202, 203
- IBC 2006
- Miami-Dade County Product Approval

## HURRICANE-RESISTANT: STORMMAX™ FG-5000 Series

These heavy-duty, flush-glazed storefronts provide significant hurricane protection with the use of both monolithic and insulating glass. FG-5000 system is available with both dry and wet glazing options. FG-5100T system is available with wet glazing option only.

### Performance

- ASTM: E1886, E1996
- Florida Building Code: TAS 201, 202, 203
- IBC 2006
- Miami-Dade County Product Approval

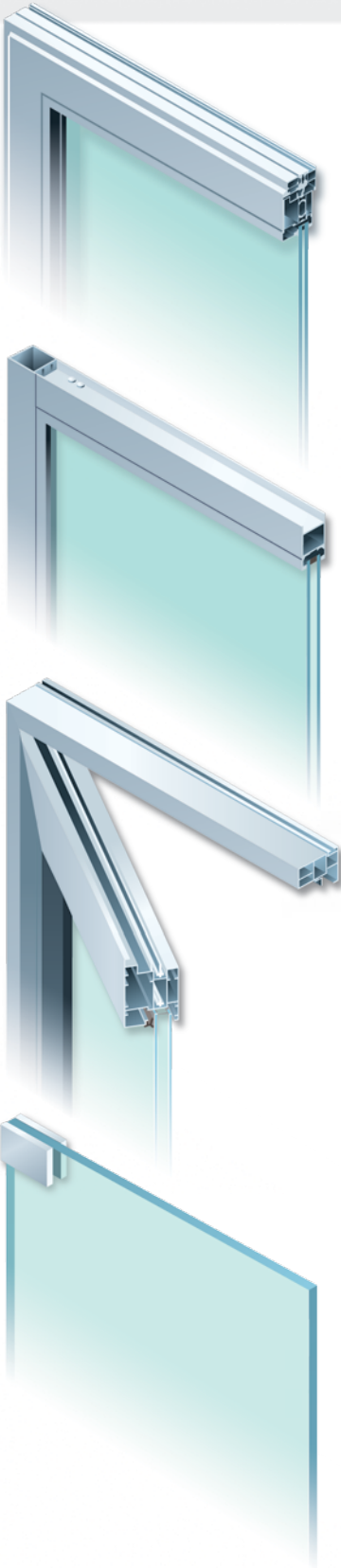

## TERRACE DOOR: SLIDING

These doors feature a 4-1/2" deep perimeter frame depth for superior strength, durability and ease of installation. Stainless steel tandem rollers allow for fluid operation. In addition, door frames side-stack for superior weather resistance.

### Performance

- AAMA: AW 80 (OX configuration)
- Air Infiltration: Less than .30 cfm/ft²
- Water Rating: 12 PSF per ASTM E331
- Cycle Test: 2,500 cycles

## ENTRANCE DOOR: ALUMINUM

Entrance doors are available in standard narrow, medium or wide stiles to meet a wide range of traffic requirements. All entrance systems incorporate heavy-duty, tubular construction and precise machining to ensure every door offers unparalleled quality and performance.

### Performance

- Air Test per ASTM: E283
- Thermal Tested per AAMA: 1503
- Blast Tested: GSA/ISC, UFC (DoD), and ASTM F1642
- Hurricane Impact Tested for Florida Building Code ASTM: E1886, E1996

## TERRACE DOOR: SWING

Terrace Doors are high-performance hinged, glazed doors. Custom-manufactured in both single and paired configurations, these doors feature clean, architectural lines for smooth and consistent operation in both inward and outward swings.

### Performance

- AAMA: AW-50 to 80 (single leaf)
- Air Infiltration: Less than .1 cfm
- Water Rating: 12 PSF per ASTM E331
- Cycle Test: 25,000 cycles
- Hurricane Impact Tested for Florida Building Code ASTM: E1886, E1996

## ENTRANCE DOOR: ALL GLASS

All-glass entrance systems are all-glass portals engineered to allow designers extraordinary flexibility. Our doors can be swinging or sliding, as well as stacking or bifold panels. Entrances can be incorporated into our Stackwall® system.

### Configurations

- P Style  
Continuous top and bottom rails
- BP Style  
Continuous bottom rail with top pivot patch fitting
- A Style  
Patch fittings at pivot corners
- F Style  
Patch fittings at top and bottom and a lock patch at the leading edge of the door



# Curtain Wall



### CURTAIN WALL: I-BEAM

I-Beam Curtain Wall is a fully captured curtain wall system suitable for low- to high-rise curtain walls and available in 2-1/2" or 3" wide profiles. Interior trims are thermally isolated from exterior climate conditions and accommodate multiple finishes, allowing for nonmatching interior and exterior profiles.

#### Performance

**Air Infiltration:** Not to exceed 0.06 cubic feet per minute per square foot of wall area when tested at 6.24 PSF per ASTM E283

**Water Infiltration:** Not less than 15 PSF when tested per ASTM E331



### CURTAIN WALL: RELIANCE

Reliance is a thermally broken, zone-glazed curtain wall system offering both captured and structural silicone-glazed vertical mullions with multiple system depths and glazing infill options, ideal for low- to mid-rise curtain wall installations. Reliance can be configured for shear block or screw spline installation.

#### Performance

**Air Infiltration:** Less than .06 CFM/sq ft when tested at 6.24 PSF per ASTM E283

**Water Infiltration:** No water penetration at 15 PSF when tested per ASTM E331 and AAMA 501.1



### CURTAIN WALL: RELIANCE-TC

The Reliance-TC Curtain Wall is built on a thermally enhanced version of our popular Reliance chassis, offering a thermally broken, zone-glazed system for both captured and structural silicone-glazed vertical mullions.

#### Performance

**Air Infiltration:** <.06 CFM/sq ft when tested at 6.24 PSF per ASTM E283

**Water Infiltration:** No water penetration at 15 PSF when tested per ASTM E331 and AAMA 501.1

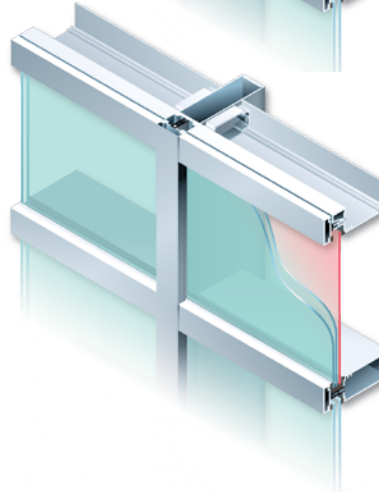

### CURTAIN WALL: RELIANCE-TC IG

Reliance-TC IG Curtain Wall provides another option within the Reliance Curtain Wall family, offering an inside-glazed system with composite vertical and horizontal mullions. All framing members are constructed with glass-reinforced insulating strips for enhanced thermal and structural performance.

#### Performance

**Air Infiltration:** <.06 CFM/sq ft when tested at 6.24 PSF per ASTM E283

**Water Infiltration:** No water penetration at 15 PSF when tested per ASTM E331 and AAMA 501.1

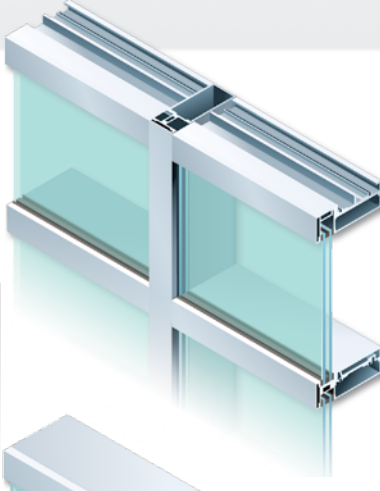

### CURTAIN WALL: UNITIZED

Factory-fabricated and glazed then installed as individual units, unitized fabrication allows buildings to be closed more quickly. Frames are normally one lite wide and one story high with double-width and double-height frames also available.

#### Performance

**Air Infiltration:** ASTM E283

**Water Infiltration:** Static ASTM E331, Dynamic AAMA 501.1

**Structural Performance:** ASTM E330

**Thermal Cycling:** AAMA 501.5

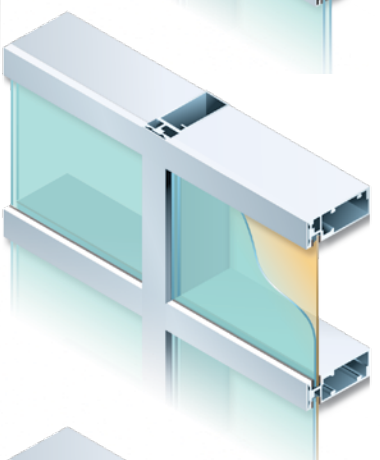

### HURRICANE RESISTANT: STORMMAX™ HR-250

Reliance is a thermally broken, zone-glazed curtain wall system offering both captured and structural silicone-glazed vertical mullions with multiple system depths and glazing infill options, ideal for low- to mid-rise curtain wall installations.

#### Performance

**ASTM:** E1886, E1996

**Florida Building Code:** TAS 201, 202, 203

**IBC 2006**

**Miami-Dade County Product Approval**

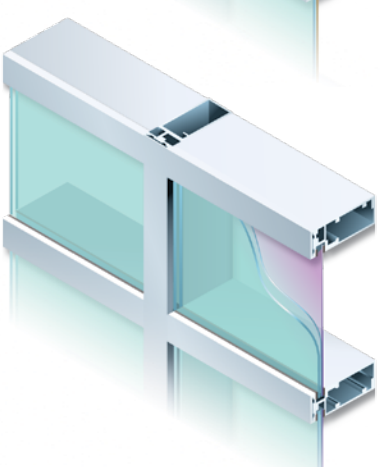

### BLAST MITIGATION: BLASTMAX™ RELIANCE

Blast arena tested with standard Reliance Curtain Wall profiles offer significant levels of blast protection with the economies of a standard system. Our blast mitigation systems are unique in that the curtain wall and the glass are engineered and tested together as one system.

#### Performance

**ASTM:** F1642

**UFC (DoD) 4-010-01**

**GSA / ISC**



### CURTAIN WALL: CUSTOM-ENGINEERED

While we offer a wide range of standard curtain wall models, we have the ability to start with a clean sheet. We employ some of the best engineers in the industry to custom-engineer the most complex of curtain wall designs.

**Project:** The Bow, EnCana Headquarters  
**Location:** Calgary, AB  
**Architect:** Foster + Partners  
**Product:** Custom-engineered curtain wall

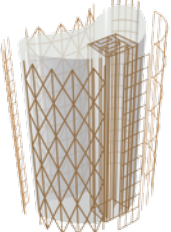

#### Modeling and Testing

We analyze thermal expansion and contraction, condensation, water diversion, even seismic conditions.



#### Full-Scale Mock-Up

Our engineers test their designs by creating full-scale building envelope mock-ups.



# Architectural Glass: Structural

# Sunshades

## STRUCTURAL GLASS: STACKWALL®

Stackwall®, an Oldcastle BuildingEnvelope® exclusive, is a structural wall system with glass panels comprising the facade and vertical glass mullions (fins) to structurally resist wind load and seismic forces. With Stackwall®, there are no visual metal obstructions.

### Capabilities

An engineered, floor-loaded maximum 40' height, or suspended-wall construction for heights up to 60', the main glass plates are joined to the mullions (fins) with metal patch or "spider" fittings and structural silicone.

## STRUCTURAL GLASS: FINWALL®

Finwall® is a structural glass wall system for openings less than 16' high. The system provides the characteristics of an exterior flush glazed wall using interior glass mullions (fins) instead of metal mullions.

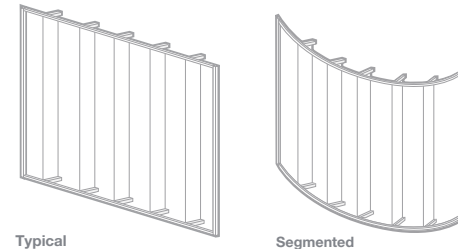

## STRUCTURAL GLASS: POINT-SUPPORT

Point-supported canopies and facades are comprised of stainless steel spider fittings and laminated glass to resist wind load and snow load requirements. Glass attachment fittings are designed to flex when the glass is under loading to reduce stresses in the glass at the fitting connection.

### Capabilities

Oldcastle BuildingEnvelope® has extensive experience in the design of structural glass systems. We offer custom-design and engineering capabilities for all structural glass applications for your project development needs.

## STRUCTURAL GLASS: CABLE NET / TRUSS

Cable Net and Cable Truss walls are unique in their design and application. These systems require review in the early stages of design to determine the proper structural requirements of the building steel. Cable Net and Cable Truss systems can integrate spider fitting or patch plate fittings.

### Capabilities

Oldcastle BuildingEnvelope® has extensive experience in the design of structural glass systems. We offer custom-design and engineering capabilities for all structural glass applications for your project development needs.

## SUNSHADES: SOLAR ECLIPSE™

Offering tremendous flexibility in both aesthetic and functional design, Solar Eclipse™ can be customized to provide beautiful building accents and provide passive solar control. Face-mount pressure plate bracket design allows easy field installation of sunshades modules.

### Performance

Modular construction for easy field installation  
2-1/2" deep (min.) exterior vertical covers required to conceal pressure plate brackets  
Outrigger plate projection depth varies based on shade structure composition

## SUNSHADES: SOLAR SHELF™

Solar Shelf™ is comprised of extruded aluminum struts with .090 panels set between a wall mount and continuous cover. The Solar Shelf™ may be ordered in depths up to 30" and with three standard interior covers or custom covers to fit your project requirements.

### Performance

Easy installation utilizing extruded components and aluminum panels  
Shear block and screw spline assembly  
Standard or custom interior covers and end caps

# Inset Panels

## INSET PANELS: METAL

With the flexibility of Aluminum Composite Metal (ACM), we have the ability to form column closures and other decorative treatments in the same finishes you see in our other architectural aluminum products. In wall panel applications Oldcastle BuildingEnvelope® can provide a traditional wet glaze system or dry glaze, designed for rain screen applications.



Available in standard or custom finishes



**We offer the most comprehensive  
portfolio of products specified to  
close the building envelope.**



**Thermal Products**

**Blast and  
Hurricane-Resistant**

**Architectural  
Glass**

**Architectural  
Windows**

**Skylights**



**Oldcastle BuildingEnvelope®**

*Engineering your creativity™*

2425 Olympic Blvd. ■ Suite 525-East ■ Santa Monica, CA 90404  
1-866-OLDCASTLE (653-2278) ■ [oldcastlebe.com](http://oldcastlebe.com) ■ [BIMIQ.com](http://BIMIQ.com)

