

Series MSD-375 BlastMax™ Entrances— blast-resistant medium stile entrance doors

After extensive blast arena testing the MSD-375 Blast Resistant Entrance Door system has **proven to be a high performance system** that meets the most stringent standards of ASTM, GSA and UFC. The MSD-375 Blast Resistant Entrance Door System performs exceptionally well without the need for reinforcing steel or special anchoring.



Features

- 1" laminated insulating glass or 9/16" laminated
- Wet-glazed
- No exposed fasteners
- Can be integrated into FG-5100 and FG-5100T and Reliance BlastMax™ systems
- Factory-painted Kynar 500®/Hylar 5000® finishes, meeting all provisions of AAMA 2605
- Factory-anodized finishing
- ASTM F1642 compliant
- UFC (DoD) 4-010-01 compliant
- GSA/ISC compliant

series MSD-375 blast-resistant entrance doors



Oldcastle BuildingEnvelope™

Engineering your creativity™

Details

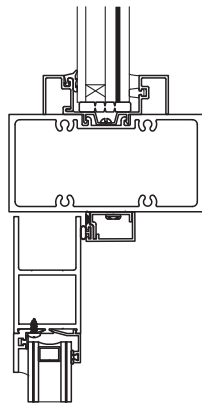

Door Header at Storefront

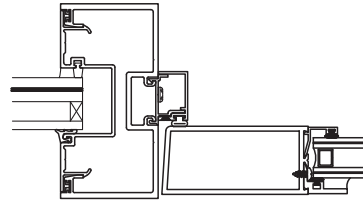

Door Jamb at Storefront

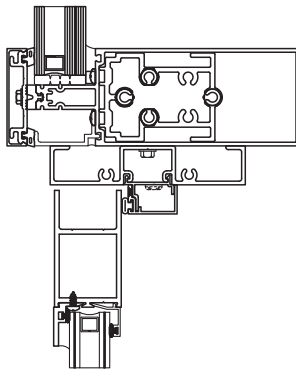

Door Header at Curtain Wall

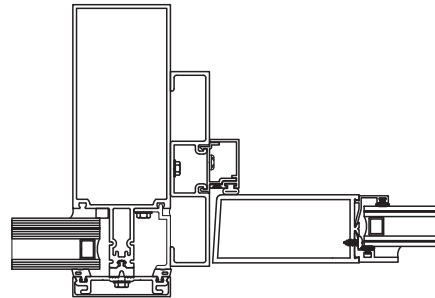

Door Jamb at Curtain Wall

Performance

- Structural Load: +70 / -80 PSF per ASTM E330

- Forced Entry Resistance Test: Passed at 300 lbs per SFBC 3603.2

- ASTM F 1642: No hazard

- UFC 4-010-01: level of protection - Medium

- GSA Performance Condition: 2

Kynar 500® is a registered trademark of Atofina
 Hylar 5000® is a registered trademark of Ausimont USA, Inc.